

Collection	Finish	Product
Classic	Polished Brass	Classic 45 Amp Double Pole Switch

## Classic Collection Classic 45 Amp Double Pole Switch

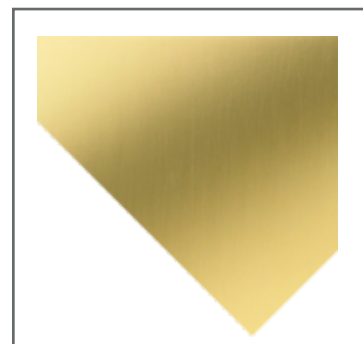
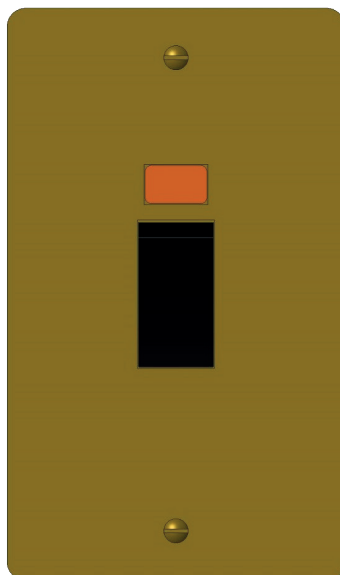
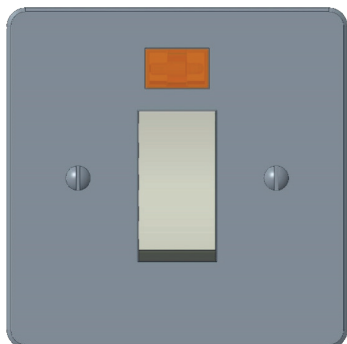

Specified in Polished Brass

### Description

A range of 45amp Double Pole switches have been designed for the connection for domestic cookers and power showers.

All units have been designed with ease of installation in mind and have the advantageous design features and quality of The Classic Collection, complete with amber neon indicators.

### Standards, Approvals & Directives

BS EN 60669

### Features

- The double pole switch has 3mm contact gaps for isolation.
- All terminal and fixing screws are operated by one size screwdriver.
- White or Black rockers
- All neon indicators are integrally wired into the product and do not require separate connection when installing.

### Ordering

When ordering please state in tabular form your requirements for plates/finishes, interior assemblies and boxes.

### Catalogue Numbers:

<b>Interiors:</b>	A0234/*	Single Gang
	A0237/*	Double Gang
<b>Plates:</b>	P0234/*	Single Plate
	P0237/*	Double Gang

/\* Denotes plate, rocker finish

Interiors available in /B - Black and /W - White.

see Wandsworth's catalogue for details

e.g P0234/PB

Polished Brass Plate

### Recommended Box Depth:

45Amp Double Pole Switch - 47mm

Metal boxes to BS4662

Collection	Finish	Product
Classic	Polished Brass	Classic 45 Amp Double Pole Switch

### TECHNICAL SPECIFICATION

Supply Voltage	Current Rating	Terminal Capacity	Ambient Operating Temperature	Max Installation Altitude	IP Rating
250V AC	45A	Live, Neutral and Earth: 2 x 6 mm <sup>2</sup> 1 x 10 mm <sup>2</sup> 1 x 16 mm <sup>2</sup>	-5°C to +40°C	2000 meters	IP2XD

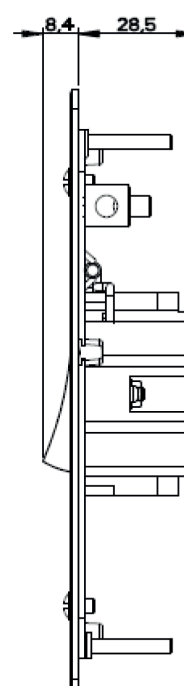
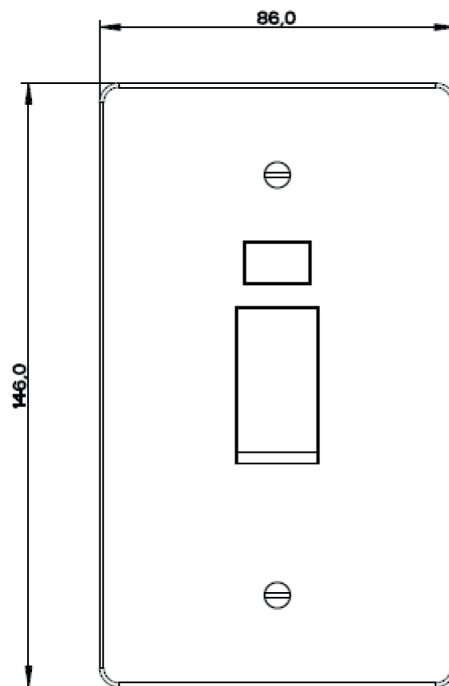
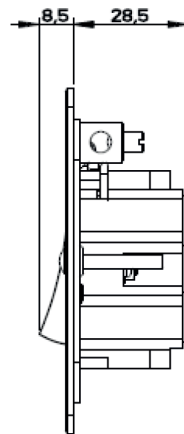
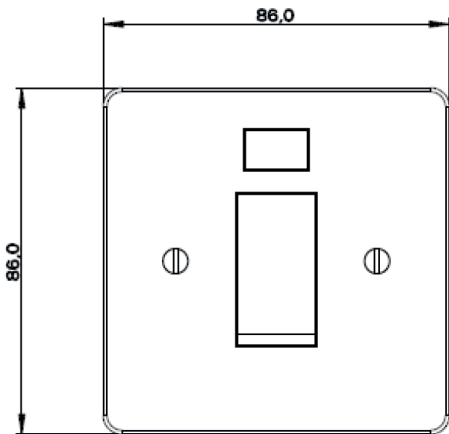

**NOTE:**

The Company Policy is one of continuous improvement and the right to change designs, dimensions, descriptive matter, etc., at any time without notice is reserved.